

## Shackle Link Plates

Link plates are primarily designed for making connection of two matching shackle pin to pin and this generally applies where multiple round slings need to be connected for applications such as head slings for a spreader beam.

Our link plates are all designed to accommodate sling saver shackles and we hold stock in our rental fleet with sizes from 18t through to 75t WLL and can supply sales requests to order.

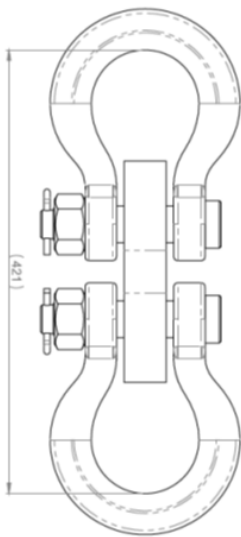

Measurement inside bow to inside bow (Van Beest Sling saver)

- 18t 421mm
- 30t 487mm
- 40t 620mm
- 55t 688mm
- 75t 826mm
- Detailed drawings are available for each size.

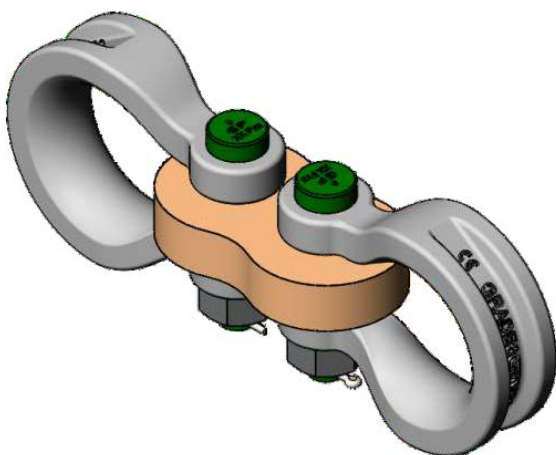

**Australia's Best  
Range of Quality  
Heavy Rigging Gear**

**CALL 03 8360 8910**

**email** [sales@dynamicrigging.com.au](mailto:sales@dynamicrigging.com.au)

**website** [dynamicrigginghire.com.au](http://dynamicrigginghire.com.au)

48c National Drive Truganina Vic 3029